

## NTC Indoor Walking Route

This 2 mile indoor walking route is very easy to follow. Starting at the Information Desk, the route uses the main hallway that connects all buildings (except I Building). Please use the instructions below to locate mileage markers. The attached campus map also highlights the route in yellow. Any questions, please contact Matt Chitwood in Student Life.

1. Start at the Information Desk and walk to the doors at the end of the H Building by Welding and Machine Tool.
2. Turn around and walk back towards the Information Desk.  
**¼ mile marker by the cafeteria entrance near E102.**
3. Walk past the Info Desk and proceed to the A Building doors (neighbors the courtyard)
4. Turn around at A Building doors and walk back to Info Desk.  
**½ mile marker across from room A107.**
5. Walk past Info Desk and proceed to H Building doors by Welding and Machine Tool.
6. Turn around at H Building doors and walk back towards the Information Desk.  
**¾ mile marker by room H109**
7. Walk past the Info Desk and proceed to the A Building doors (neighbors the courtyard)  
**1 mile marker by the Men's Bathroom in A Building**
8. Turn around at A Building doors and walk back to Info Desk.
9. Walk past Info Desk and proceed to H Building doors by Welding and Machine Tool.  
**1 ¼ mile marker across from G102**
10. Turn around at H Building doors and walk back to Info Desk.
11. Walk past the Info Desk and proceed to the A Building doors (neighbors the courtyard)  
**1 ½ mile marker by the Library**
12. Turn around at A Building doors and walk back to Info Desk.  
**1 ¾ mile marker kitty-corner across from Library**
13. Walk past Info Desk and proceed to H Building doors by Welding and Machine Tool.
14. Turn around at H Building doors and walk back to Info Desk.  
**2 mile marker in F Building**

CAMPUS DRIVE

Center for Geriatric Education

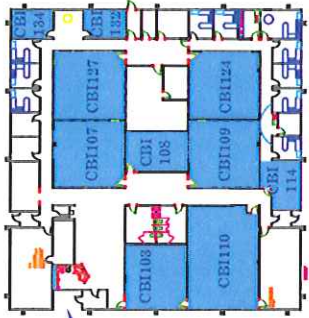

Center for Business and Industry Entrance

WLS Building Parking Lot D

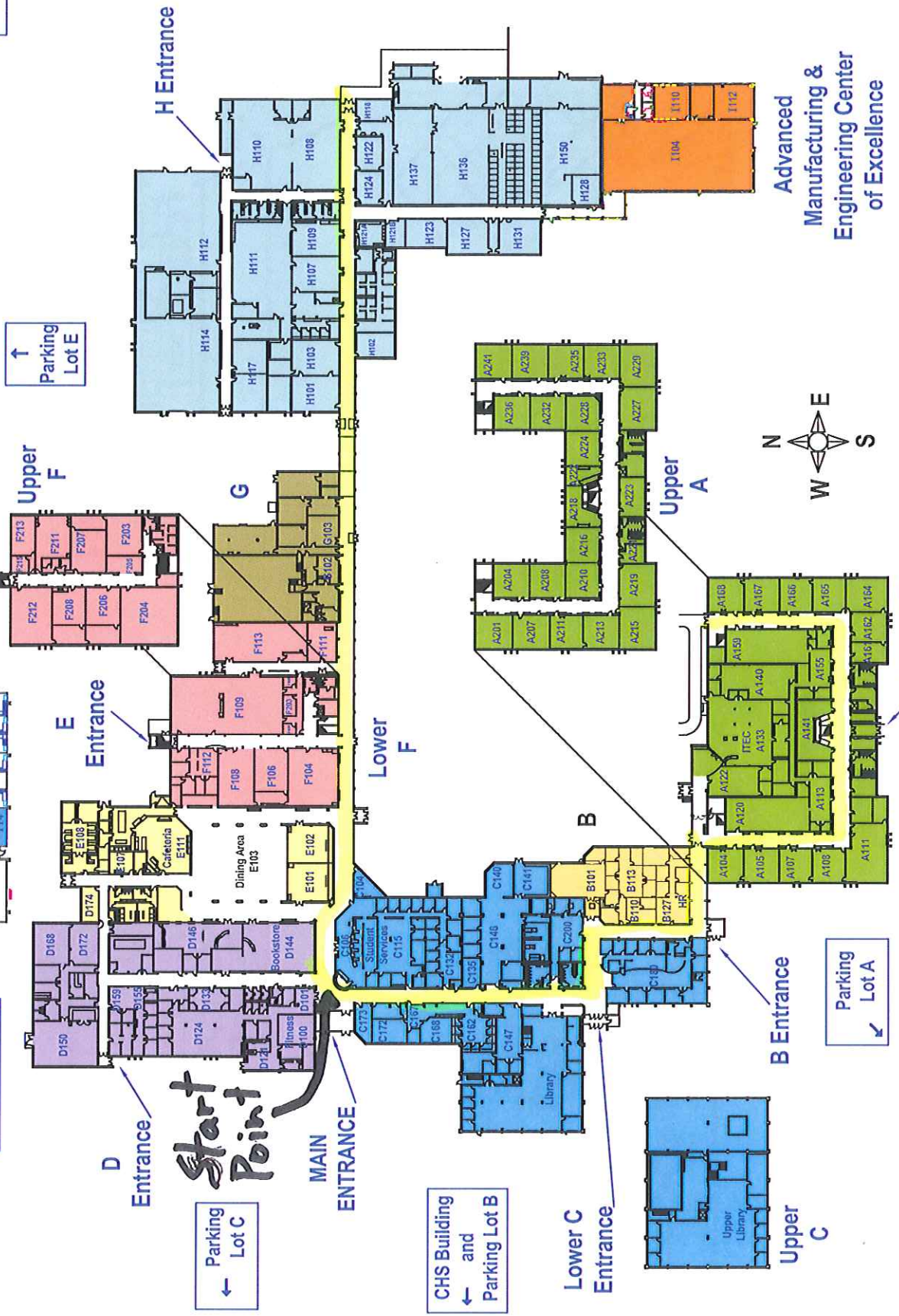

Parking Lot C

CHS Building and Parking Lot B

Parking Lot A



Advanced Manufacturing & Engineering Center of Excellence

H Entrance

Parking Lot E

Upper F

E Entrance

D Entrance

MAIN ENTRANCE

Lower F

Lower C Entrance

Upper C

B Entrance

Lower A Entrance

Upper A

Start Point